

LASOS[®] DPSS-XT laser series



Diode-Pumped
Solid State Laser Modules

Distribution in the UK & Ireland



Lambda Photometrics Limited

Lambda House Batford Mill
Harpenden Herts AL5 5BZ
United Kingdom

E: info@lambdaphoto.co.uk

W: www.lambdaphoto.co.uk

T: +44 (0)1582 764334

F: +44 (0)1582 712084



LASOS

For worldwide photonics



Diode-pumped solid-state laser modules

LASOS® DPSS-XT laser series











The LASOS® DPSS-XT laser series is the best choice when reliability and long lifetime matters. The special optical design and an intelligent power and temperature control guarantee

- Excellent long-term stability
- Low noise
- Exceptional good beam quality
- Long lifetime

These characteristics are ideal for a variety of applications as in DNA sequencing, flow cytometry, digital imaging, analytical chemistry, fast-flow-rate particle measurements or confocal microscopy. Single frequency lasers, emitting only a single longitudinal mode are also an ideal choice for application in Raman-spectroscopy. Housed in compact and robust packages, these lasers are the perfect choice for design in and integration into OEM instrumentation and systems and also for end user applications in research and development.

Due to the fully integrated control electronics the lasers can be provided as selfcontained modules for OEM integration or with stand alone option for laboratory use. All models can be operated by the software LASOS® Commander via USB interface.

Customized solutions for specific applications are possible. All laser models can be provided with a polarization maintaining, adjustment free fiber coupling.

Model key	DLK-XT	BLK-XT	GLK-XT		YLK-XT				RLK-XT			
												
Wavelength [nm]	320	473	532	543	552	556	561	594 ¹⁾	607	640	640 ¹⁾	
Max. output power [mW] ²⁾	20	100	300	50	50	50	150	20	50	200	500	
Max. beam divergence [mrad]	0.7	1.1	1.2			1.3			1.4			
Line width [MHz] ³⁾	< 1								< 1			
RMS noise (30 Hz-10 MHz) [%]	< 2	< 0.5						< 1	< 2			
Wavelength stability (8h) [nm]	< 0.005								< 0.5	< 0.005		
Beam diameter	0.7 (0.32 on request)											
Beam ellipticity	0.85 ... 1.15											
Beam quality M ² (TEM ₀₀)	< 1.2											
Power stability (8h) [%]	≤ 2											
Pointing stability [μrad/K]	< 6											
Polarization ratio (vertical)	> 200:1											
Warm up time [min]	< 10											
Operating voltage	12 V											

Values are general specifications. Parameters for particular models may differ, refer to www.lasos.com

All lasers operate single frequency except ¹⁾

²⁾ Refer to figure below for selection of output powers

³⁾ Allan Deviation for sample period < 0.5 s

For enquiries specify: Model key WavelengthOutputPower TS

Example for DPSS 532 nm, 200 mW: GLK-XT 532200 TS

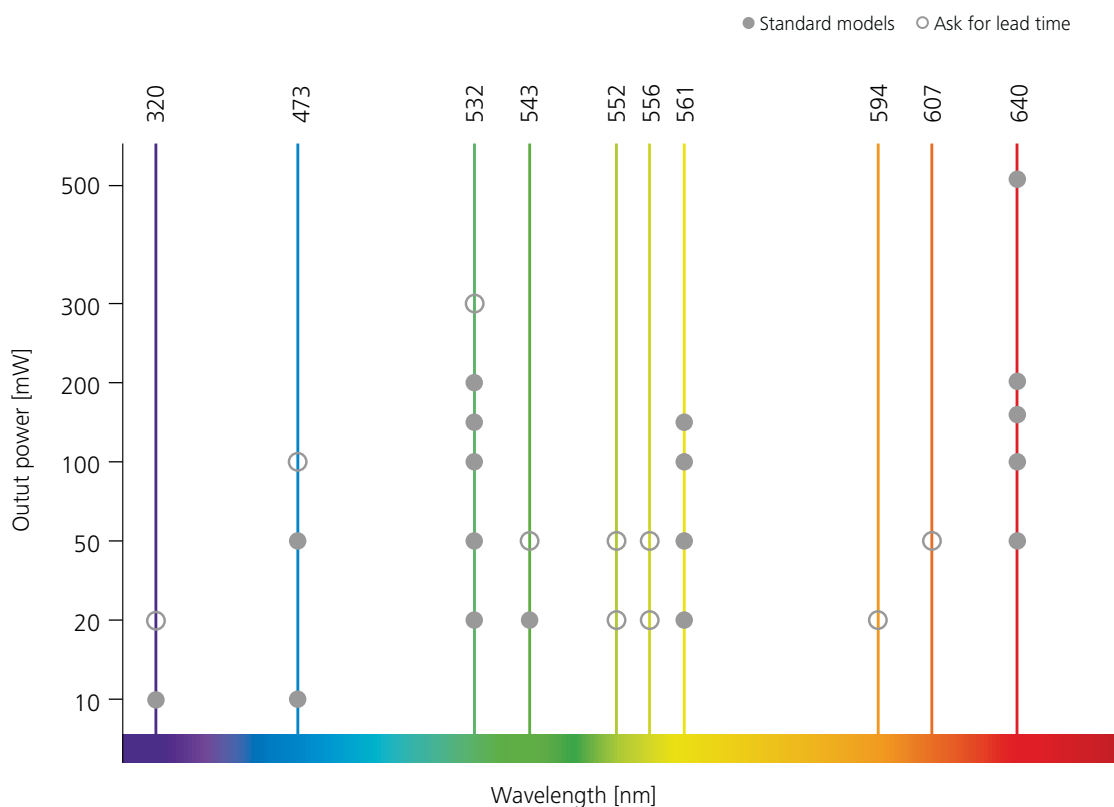

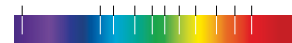

Dimensions [mm]:

Laser head

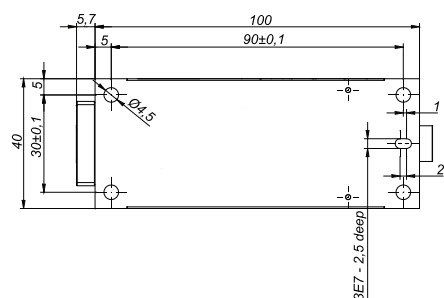

Laser head fiber coupled

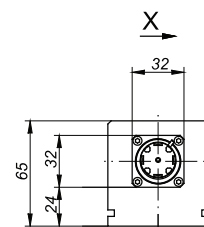
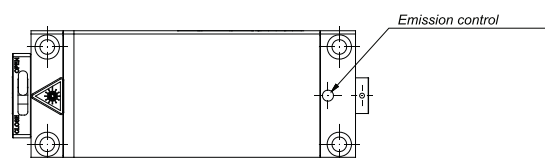
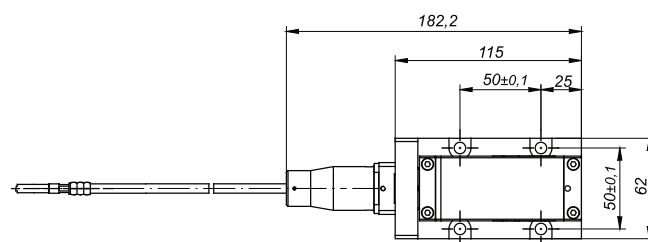
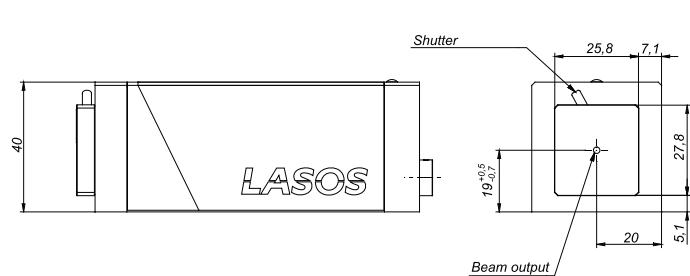
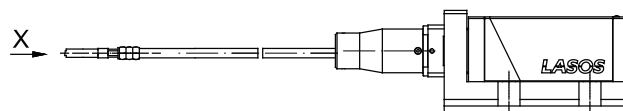

Accessory: Stand alone kit for LASOS DPSS-XT laser series:

Heat sink LHA 1200:

Software:

SwitchBox SSL 1000,
CDRH compliant

Power supply 12 V,
power cord and interface
cable included

Operating voltage: 12 V DC
Operating current:
80 mA

LASOS Commander

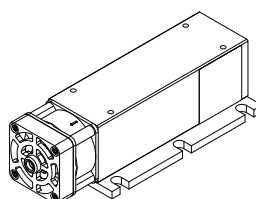
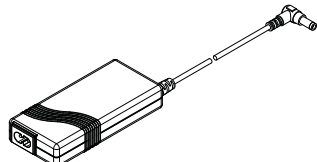
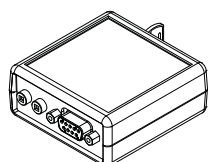

LASOS

For worldwide photonics

Distribution in the UK & Ireland



Lambda Photometrics Limited

Lambda House Batford Mill

Harpenden Herts AL5 5BZ

United Kingdom

E: info@lambdaphoto.co.uk

W: www.lambdaphoto.co.uk

T: +44 (0)1582 764334

F: +44 (0)1582 712084